

## Installation Guide:

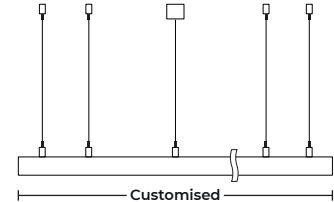

## Mounting Options:

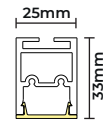
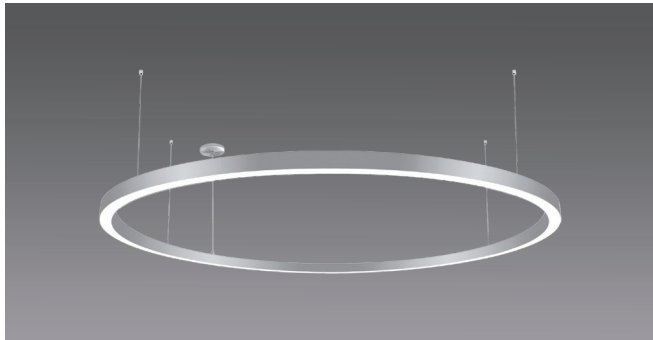

## General Notes and Cautions:

- These points to be read and followed in conjunction with pictorial installation instruction of CS25 Linear Luminaire.
- Only qualified and experienced personnel should perform the designing, installation, commissioning, operation and maintenance of lighting system conforming to latest applicable standards and codes.
- All civil, interior fit-out, electrical, control, lighting and commissioning related work for the installation, commissioning, operation and maintenance of these luminaires be performed by qualified and experienced team of supervisors, technicians and labor force.
- Ensure power supply is off during installation, electrical and control connections and maintenance activities. Take all precautionary measures and use PPE (personal protective equipment) to prevent electric shock and accidents.
- Mandatory to have proper grounding of luminaire.
- Luminaires to be fed from a compliant stable electrical system; panel, circuit protection devices including ELCBs, surge protectors, isolators, emergency power switch off etc.
- These luminaires are IP20 rated and are for indoor use only and not meant for environment having dust, suspended fibers, dirt, moisture, chemicals, fumes etc. during installation and operation phases.
- Don't operate on generator or temporary power supply.
- Power supply must conform to input power supply rating of driver and be without any variations and distortions (transient voltages, spikes, unbalanced load, THDs, fluctuation).
- Follow power and control (polarity sensitive and applicable for dimming luminaire) connections as marked on the product connection terminals and driver. In case of any ambiguity, do contact us before doing any termination and energization should be done once 100% sure about correct connections.
- Recommended to first have a mockup installation at site prior to execution of work to eliminate any non-conformance related to civil, electrical and lighting works.
- Strongly recommended to first install the profile and later install LED modules after completion of work at site and chances of exposure to dust, moisture, humidity, paint and chemical fumes etc. are completely eliminated.
- During construction phase, protect luminaire profile and LED modules from construction related pollutants; dust, moisture, chemicals, paint and physical damage etc.
- Never operate luminaire if covered with any protective sheet/coverings etc.
- Don't alter or modify the luminaire.
- Don't repair on your own non-functioning luminaires.
- In case of malfunction, switch off the power supply immediately and don't try to repair the faulty luminaire.
- Perform any maintenance work only in consultation with our technical team and use spares provided by us.

## Accessories:



Surface Mounted  
Bracket  
SMB25

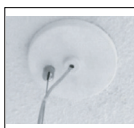

Suspension Kit  
with Power  
SKP25

## Installation Guide:

### Luminaire Assembly

#### 1 - Profile Interconnection

1. Insert the connectors into the corresponding slot, then assemble the profiles into two semicircles and make up a whole circle

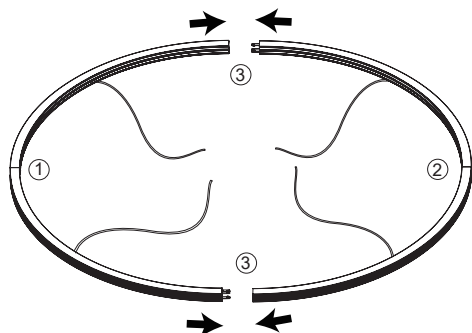

2. Fasten the screws on the back and side of the connectors through the allen wrench

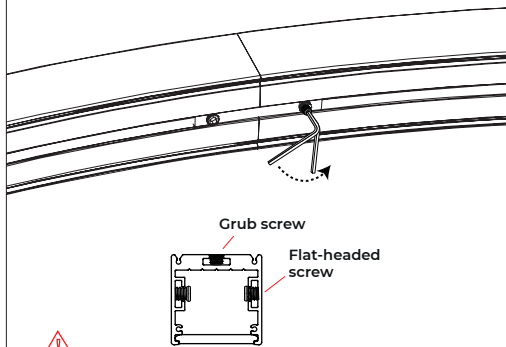

At the lateral, please use the flat-headed screw; at the back, please use the grub screw, if not, it will damage the appearance of the luminaire

#### 2 - Light Source Interconnection

Connect the light source with the wire (4 positions)

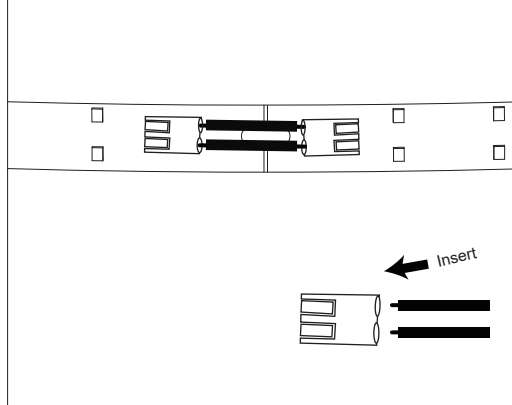

Tear up the 3M tape on the back of the LED strip, thread the wire through the outlet hole, and place the LED strip into the profile

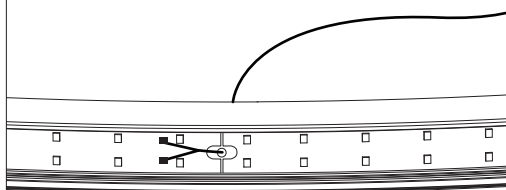

To ensure the brightness consistence of the luminous surface, please weld the head&tail end of the LED strip

#### 3 - Diffuser Installation

Press the silicone diffuser into the luminaire by your fingers

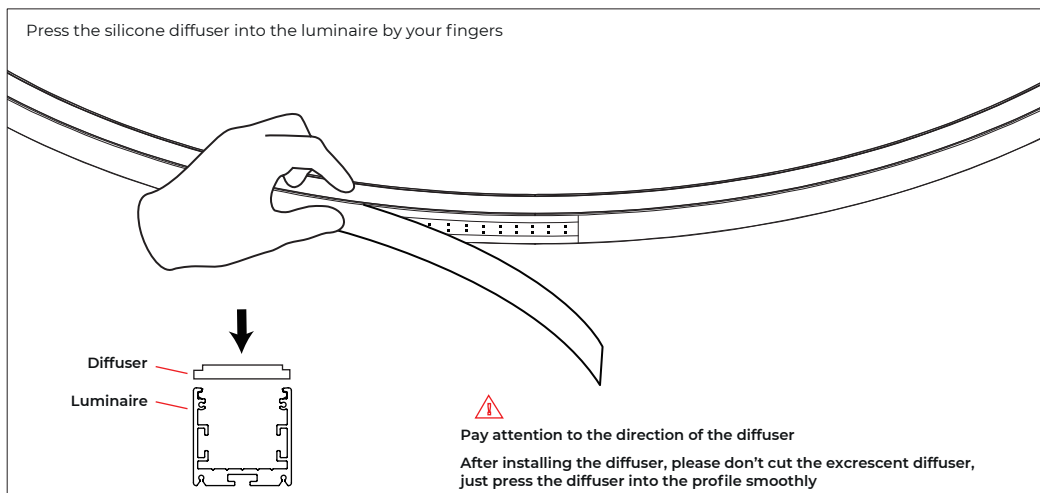

Pay attention to the direction of the diffuser

After installing the diffuser, please don't cut the excrement diffuser, just press the diffuser into the profile smoothly

## Installation Guide:

### Luminaire Assembly

#### 4 - Installation of Pendant Wire

Thread the pendant wire through the outlet hole on the canopy, adjust the wire length, and fasten the screws through the allen wrench, connect the wire to the power supply

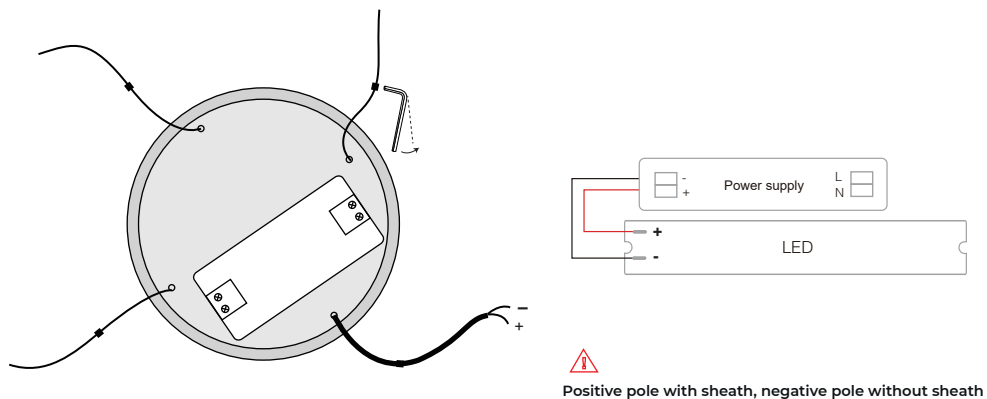

#### 6 - Fill the interconnected gap with silicone gel according to the actual situation

## Installation Guide:

### 1 - Pendant

**1**

1. Fix the bracket on the ceiling with screws

**2**

2. Wiring with the power supply

**3**

3. Thread the screws of the bracket through the canopy, fasten it with decorative screws

**4**

4. Finished

### 2 - Surface Mounted

**1**

1. Punch the  $\phi 10\text{mm}$  outlet hole into the ceiling, and thread the wire of the luminaire through the hole

**2**

2. Fasten the luminaire with screws

**3**

3. Wiring with the power supply

**4**

4. Finished

#### Disclaimer:

LuxeLED All rights reserved. LuxeLED does not give any representation or warranty as to the accuracy or completeness of the information included herein and shall not be liable for any action in reliance thereon. The information presented in this document is not intended as any commercial offer and does not form part of any quotation or contract, unless otherwise agreed by LuxeLED.